

# Port-El 2 Installation and usage instructions

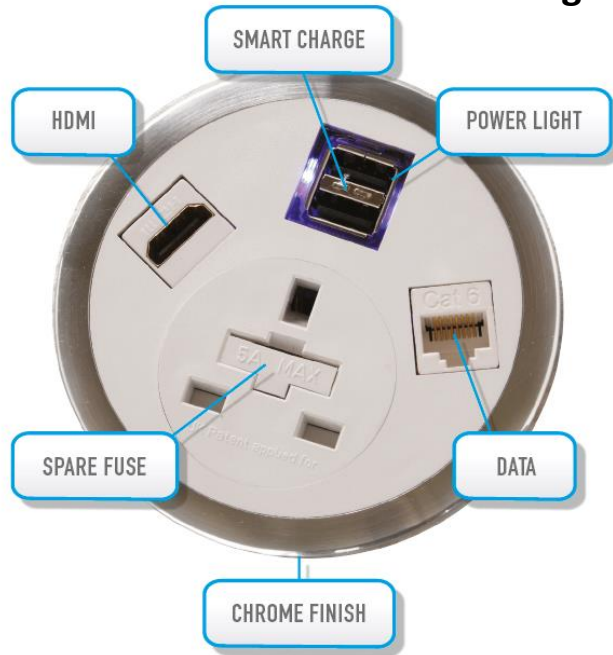

The Multi Configuration Grommet Module capable of delivering a range of power and data straight to your desktop



## 1) Importance of Correct Installation

To ensure that the module works correctly, please make sure the unit is placed onto a smooth surface free from any rough materials.

## 2) Port-El 2 Size Requirements

Before insertion, please make sure there is sufficient clearance: 150mm below surface & 30mm between the cut out edge of the work surface.

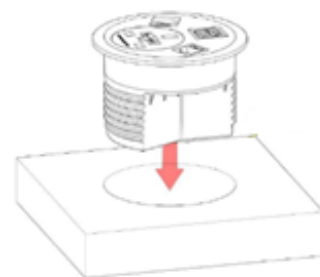

## 3) Desk Mounting

Lower the port-El 2 into the 80mm hole until the module sits in the desk. Whilst twisting the locking ring, please ensure the desired orientation is unchanged.

## 4) Operation

Using the mains extension lead that can be supplied, connect directly into the bottom of the product. If included, please also plug the other connection leads into the sockets. (Ensure the non-booted end is plugged into the product) A blue light will indicate the power module is ready to use.

## 5) Spare Fuse

To change the fuse, please **TURN ELECTRICITY OFF** and wait for 10 minutes before operation. Use a flat screwdriver (5mm width) to pull carrier with fuse and replace with spare one.

## 6) Maintenance and Care

There are no user serviceable parts in this product, a suitable competent person may replace fuses or make alterations to lead lengths should this be necessary. Please consult your electrical adviser regarding the annual testing of equipment in your office.

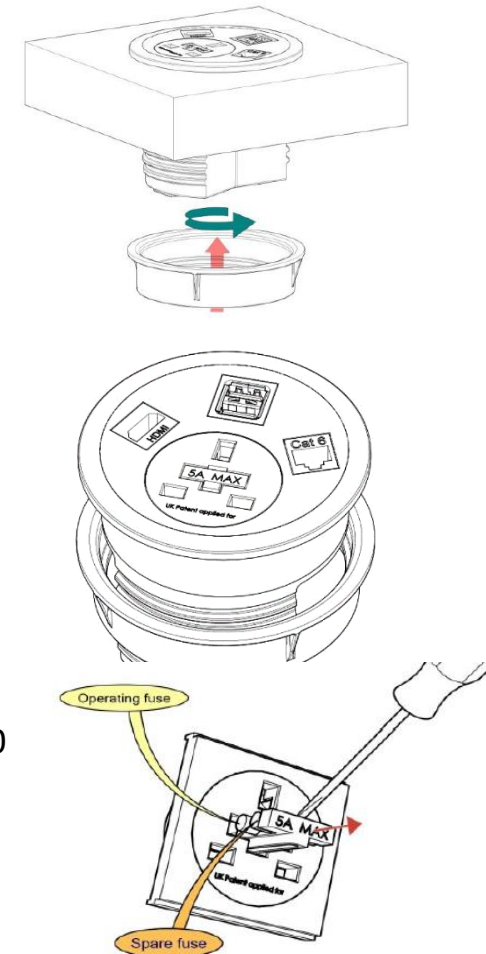

# Technical Specification



**Thank you for purchasing ABL's Port-El 2 power module unit. Port-EL 2 has been manufactured and tested in accordance with relevant British Standards. This will enable the requirements of BS6396:2008 to be met (if installed and tested as specified in the standard) Once installed and tested, any modifications should be carried out by a competent person.**

**USE:** This power module is designed for use in office and educational establishments only. The individual fuse rating for each socket will be a maximum of 5A as specified on the product, any item of equipment rated in excess of 5 Amp, **MUST** have a separate power supply, therefore items such as Vacuum Cleaners, Kettles, Coffee Makers, and Fan Heaters should not be connected via these power modules.

**FUSES:** The fuses in the product are ceramic 5mm x 20mm either 3.15A or 5A rated. Should replacements be required please contact the company that supplied this product.

**FIXING:** Use only the fixings shown in the leaflet to mount this product.

**CONNECTION:** Using the mains extension lead that may be supplied, connect the lead directly into the rear of the product. If included in this product also plug the other connection leads into the sockets on the rear of the product (ensure the Non Booted end is plugged into the product) Should you need to re-site this product and require shorter or longer leads, simply replace the leads supplied with the appropriate length leads which can be obtained from the supplier of the product.

**EARTHING:** The Earth Point on the rear of this product is provided so that the furniture may be earthed via this system if required. 'Earth Designated Furniture' The furniture manufacturer should be able to advise if their furniture requires earthing or not. **THIS PRODUCT IS EARTHED INTERNALLY AND NO FURTHER EARTHING SHOULD BE REQUIRED, (For High Density earth requirements please consult a suitably competent person)**

**MAINTENANCE:** There are no user serviceable parts in this product, a suitably competent person may replace fuses or make alterations to lead lengths should this be necessary

**INSTALLER, PLEASE LEAVE THIS SHEET WITH THE END USER FOR FUTURE REFERENCE.**